

Nozzle Extension

Model Lengths 36" – 72"



atmosphere is everything

14716 S. BROADWAY, GARDENA, CA 90248 • Ph: (310)532-1555 Fax: (310)-532-3030 • www.marsair.com
© Copyright Mars Air Systems, LLC 2014

Nozzle Extension for Unheated and Heated Models

Model Number*	Overall Length A (in)	Air Curtain Series	Applicable Air Curtain Models Length (in)	Extension Range (in)	Nozzle Depth B (in)
10-336	36	STD2/N2/HV2/NH2/EP2/PH10/PH12	36	Adjustable, 9" to 16"	4"
10-342	42	STD2/N2/HV2/NH2/EP2/PH10/PH12	42, 84	Adjustable, 9" to 16"	4"
10-348	48	STD2/N2/HV2/NH2/EP2/PH10/PH12	48, 96	Adjustable, 9" to 16"	4"
10-360	60	STD2/N2/HV2/NH2/EP2/PH10/PH12	60, 120	Adjustable, 9" to 16"	4"
10-364	64	STD2/N2/HV2/NH2/EP2/PH10/PH12	64	Adjustable, 9" to 16"	4"
10-372	72	STD2/N2/HV2/NH2/EP2/PH10/PH12	72, 144	Adjustable, 9" to 16"	4"
10-092	36	LPV2/LPN2	36	Adjustable, 8" to 16"	2 11/16"
10-094	42	LPV2/LPN2	42, 84	Adjustable, 8" to 16"	2 11/16"
10-096	48	LPV2/LPN2	48, 96	Adjustable, 8" to 16"	2 11/16"
10-156	60	LPV2/LPN2	60, 120	Adjustable, 8" to 16"	2 11/16"
10-119	72	LPV2/LPN2	72, 144	Adjustable, 8" to 16"	2 11/16"

* Append color to end of model number: "-OB" = Obsidian Black; "-TS" = Titanium Silver; "-PW" = Pearl White

Features:

- ❖ This product is designed to be compatible with Mars Air Systems models. See table for model selection chart
- ❖ Standard color for LPV2/LPN2 and STD2/NH2 is Obsidian Black (OB) and for HV2/NH2/EP2 is Titanium Silver (TS) and for PH10/12 is Pearl White (PW)
- ❖ Shipped loose for field installation
- ❖ Low profile, self-contained one-piece heavy gage corrosion proof paint lock metal design
- ❖ Lightweight construction for easy shipping and installation
- ❖ Trim pieces are included for clean installation
- ❖ Helps absorb noise produced by air flow
- ❖ Adjustable nozzle extension up to 16"
- ❖ Nozzle extension is designed to have minimum effect on air performance with no greater than 10 % reduction in projection velocity.
- ❖ Freight not included
- ❖ Proudly Made in the USA
- ❖ Field installation by others
- ❖ 1-year parts warranty

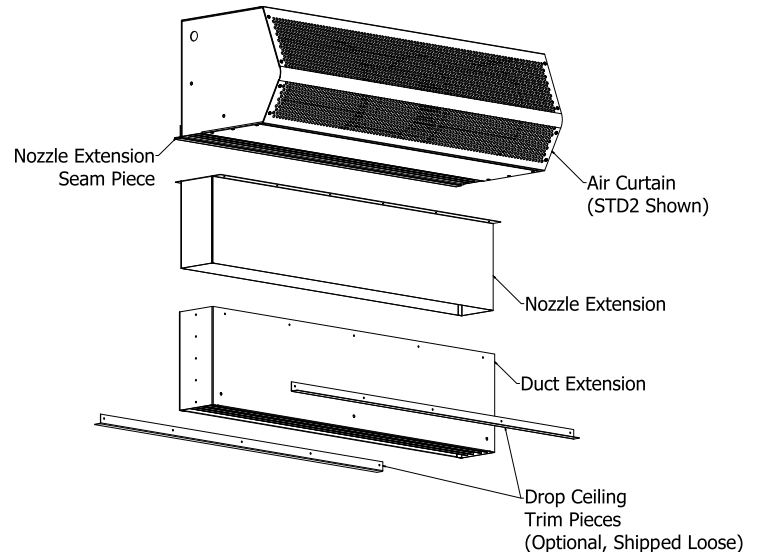

Options and Accessories:

- ❖ Custom colors available (Obsidian Black, Titanium Silver, Pearl White, Stainless Steel)

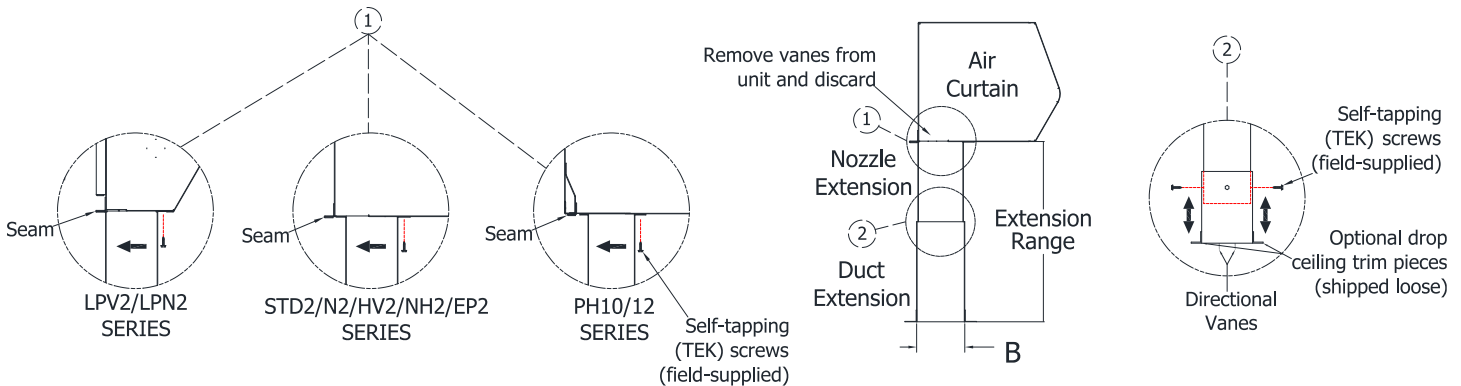

Note: Once unit and nozzle extension are installed, adjust duct extension to ensure the bottom is about 1" above door header