

Customer/Wholesaler:	Date:	Job Name:	Model Specified:	Quantity:
Contractor:		Architect/Engineer:		

MODEL	DESCRIPTION	DIM A	DIM B
2928	PRERINSE SPG 21R	9 7/8" [251mm]	37 3/8" [950mm]
75595	PRERINSE SPG 21R 7 PLUS	9 7/8" [251mm]	37 3/8" [950mm]
97993	PRERINSE SPG 16R	4 3/16" [107mm]	31 11/16" [805mm]
75594	PRERINSE SPG 16R 7 PLUS	4 3/16" [107mm]	31 11/16" [805mm]

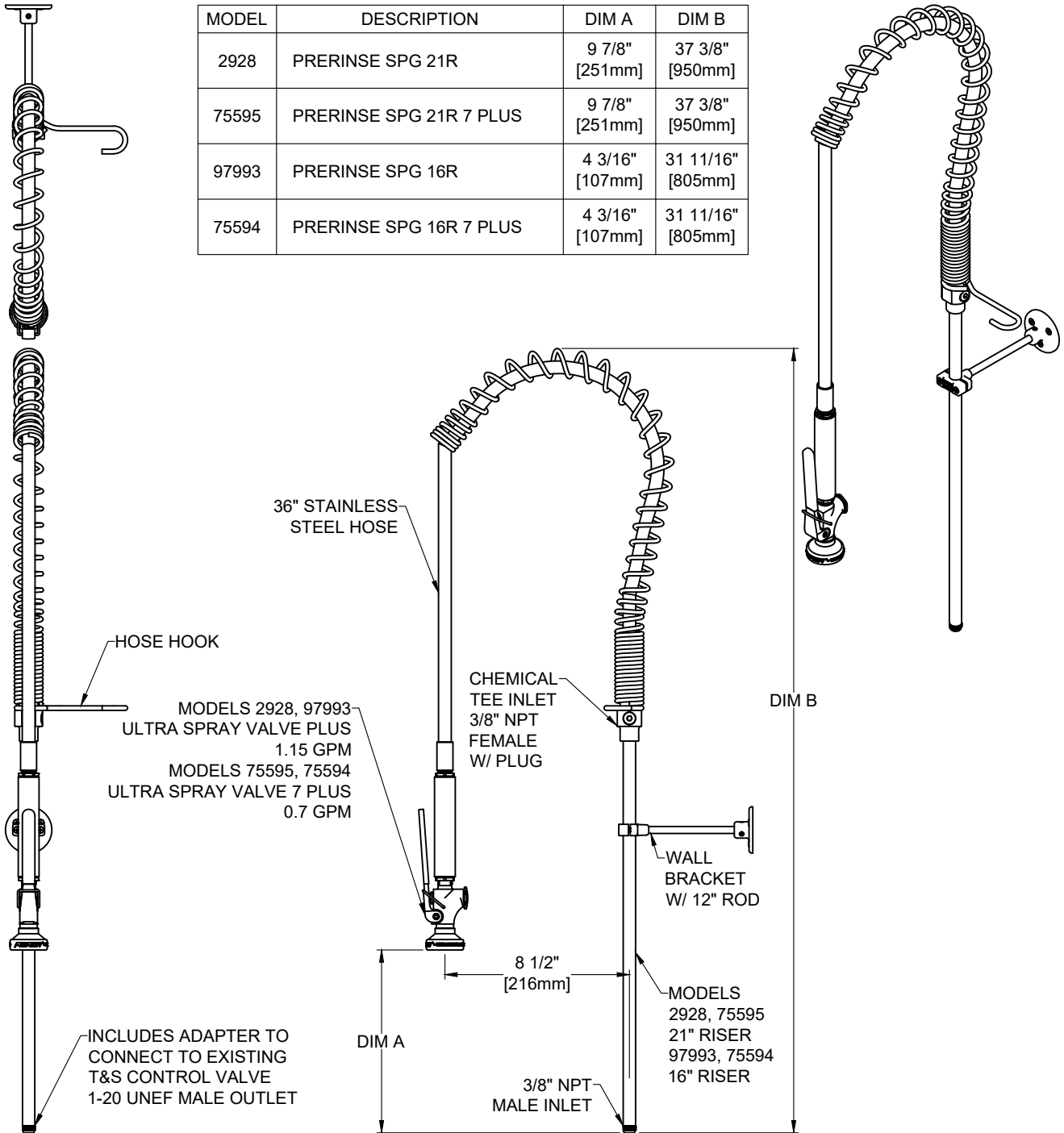

PRODUCT SPECIFICATIONS: SPRING PRERINSE UNIT, ULTRA SPRAY PLUS 1.15 GPM OR ULTRA SPRAY 7 PLUS 0.70 GPM @ 60 PSI SPRAY VALVE, 21" OR 16" RISER, 36" HOSE, T&S ADAPTER

PRODUCT COMPLIANCE:  
ASME A112.18.1 / CSA B125.1  
NSF 61 - Section 9  
NSF 372 (Low Lead Content)  
2019 DOE PRSV - Class I or II



FISHER MANUFACTURING COMPANY TOLL FREE: 800-421-6162 - FAX: 800-832-8238  
customer@fisherfaucets.com - www.fisherfaucets.com

PRODUCT NAME:

PRERINSE SPG R

SPEC. PRHB-SP-XX

Customer/Wholesaler:	Date:	Job Name:	Model Specified:	Quantity:
Contractor:		Architect/Engineer:		

# REPLACEMENT PARTS

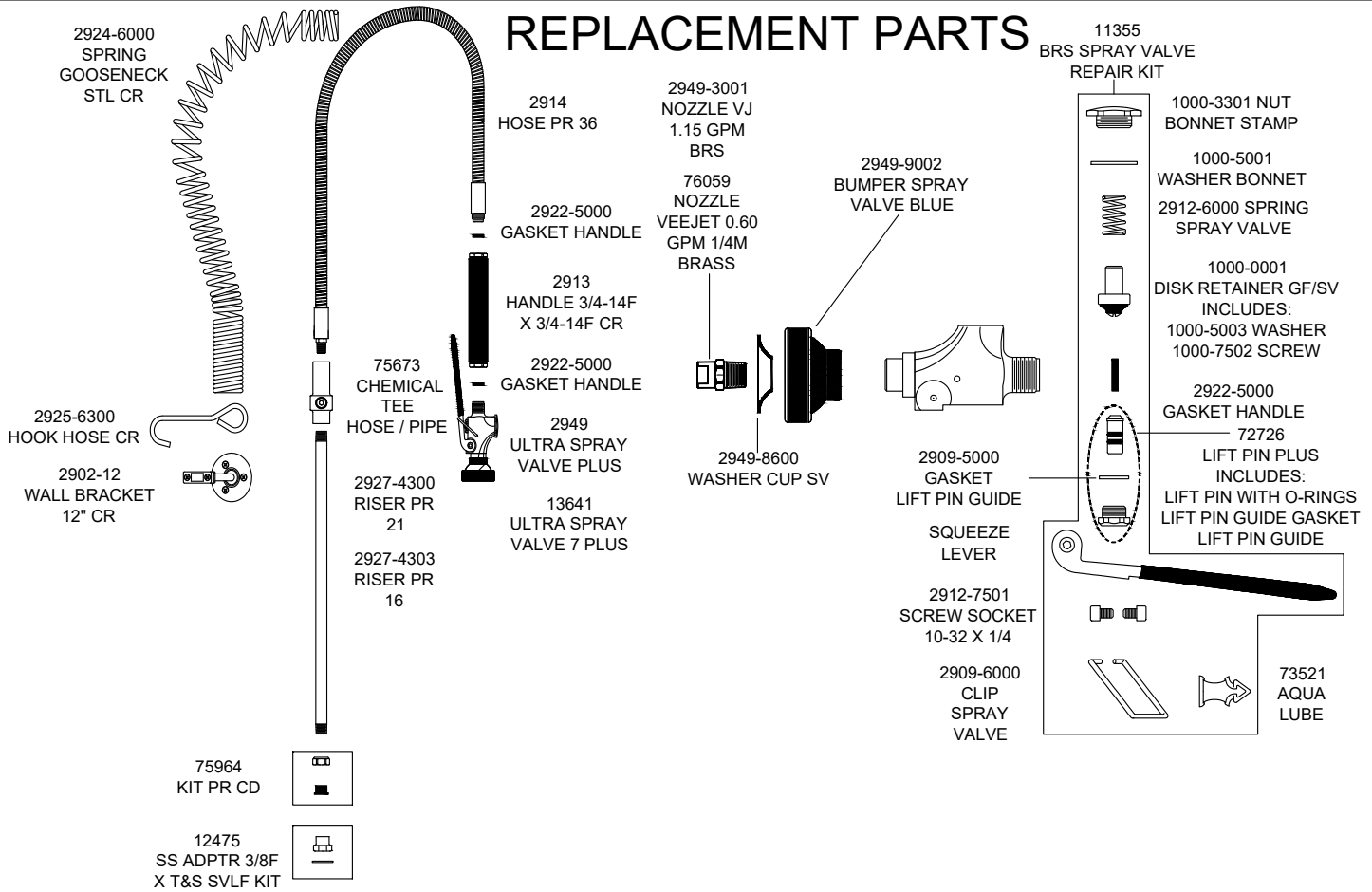

PRODUCT SPECIFICATIONS: SPRING PRERINSE UNIT, ULTRA SPRAY PLUS 1.15 GPM OR ULTRA SPRAY 7 PLUS 0.70 GPM @ 60 PSI SPRAY VALVE, 21" OR 16" RISER, 36" HOSE, T&S ADAPTER

PRODUCT COMPLIANCE:  
ASME A112.18.1 / CSA B125.1  
NSF 61 - Section 9  
NSF 372 (Low Lead Content)  
2019 DOE PRSV - Class I or II