

Fusion

Self-Service Refrigerated Open Reach-In - 85"H

Structural Concepts®

DELIVERING FRESH. ALWAYS.™

- **MD485R** 50-1/4"L x 37-1/8"D x 85-1/2"H
- **MD685R** 74-1/4"L x 37-1/8"D x 85-1/2"H

Included

- Breeze self-contained refrigeration
- LED top & shelf lights
- One year parts & labor warranty
- Open reach-in front
- Stainless steel rear exterior
- Warmest average product temperature of 40°F or less



MD485R

Specify	Standard Features	Additional Options
EXTERIOR COLOR	• Laminate (stock colors)	• Laminate (non-stock colors) • Powder coated (stock/non-stock colors) • Powder coated Silversan Black • Stainless steel
INTERIOR COLOR	• Powder coated Silversan Black	• Powder coated Designer White • Stainless steel
LOWER FRONT PANEL COLOR	• Powder coated Silversan Black	• Powder coated (stock/non-stock colors) • Stainless steel
BASE SUPPORT	• Casters w/ levelers (self-cont.)	
BUMPER FRONT	• 1" Boston bumper (specify color)	• 1" Stainless steel plate rail bumper
END PANELS	• Full w/stainless steel interior	• None (specify per line-up)
HEADER	• Flat header	
VINYL GRAPHICS	• None	• Full wrap graphic set • Logo graphic only
PRICE TAG MOLDING	• None	• 1" Price tag molding (black or silver) • Universal price tag molding (clear w/ open top)
REAR DOORS	• None (solid back panel)	• Solid rear swinging door(s) w/lock
SHELVING	• (5) Lighted solid shelves	• (4) Lighted solid shelves (required for milk crate drip pans)
LIGHTS	• LED 3500K w/ frosted lens	
ELECTRICAL CONNECTION	• 6' Straight blade power cord (self-cont.)	• 6' Locking power cord (self-cont.)
REFRIGERATION	• Breeze self-contained refrigeration	
MISCELLANEOUS		• Second year parts & labor warranty (excludes compressor)
ACCESSORIES		• Night curtain, retractable, non-locking 1 • Stainless steel milk crate drip pans

Option Notes: 1 - N/A with (5) shelves

Intended Environment: Type I - Designed to operate in ambient conditions of 75°F with 55% relative humidity unless noted otherwise in system information below.

Zone	Intended Product To Be Displayed	Warmest Avg Prod Temp ° F
1	Packaged / unpackaged refrigerated products-Prechilled to Warmest Avg Prod Temp.	40

PLAN VIEW

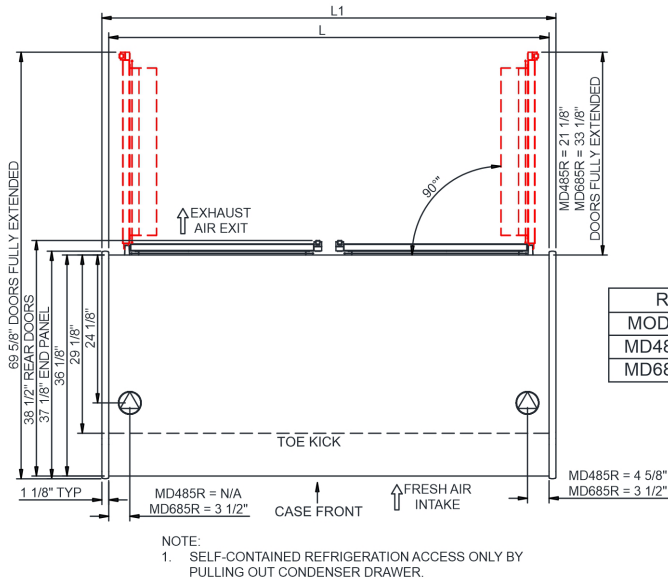

MODEL	WD x HT x QTY
MD485R	17" x 57 3/4" x 2
MD685R	28 5/8" x 57 3/4" x 2

SIDE VIEW

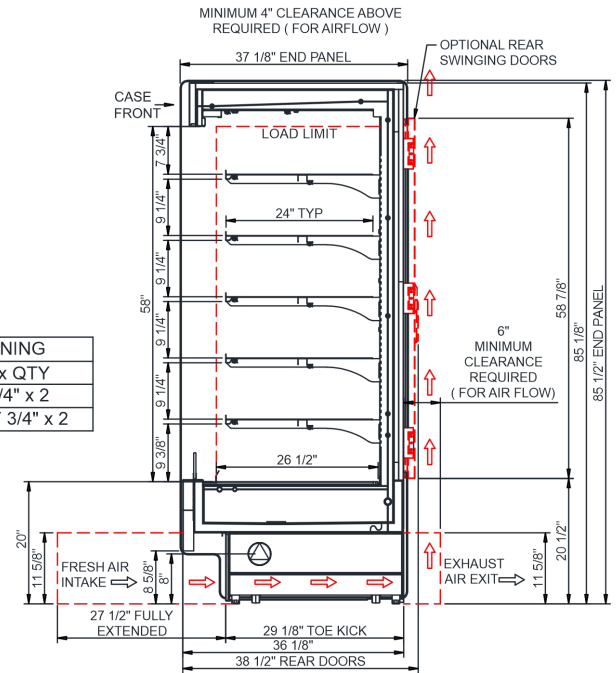

NOTE: ALL DIMENSIONS APPROXIMATE

⊕ ELECTRICAL JUNCTION BOX
(SUPPLIED WITH 6" LEADS OR POWER CORD).
⊖ LOCATION OF DRAIN TUBE FOR REMOTE REF.
ONLY (SUPPLIED WITH 3/4" OR 1 1/2" PVC TUBE).

⊕ REFRIGERATION LINE CONNECTION.
⊖ REMOTE FLOOR SINK & UTILITIES
ACCESS AREA.

⊕ SELF-CONTAINED CASE SERVICE ACCESS AREA.
⊖ DRY CASE SERVICE ACCESS AREA.

Model Technical Specifications																
Model	L"	L1"	L2"	System Circuit Volts			Phs	Freq	Amps ***	Watts	Wires	NEMA Plug	SST	Conv. Rack BTU/H	Para. Rack BTU/H	Est Wt
MD485R	48.00	50.25	3.00	Self-Contained (R290)	Circuit #1	208-240	1	60	16.00	2,864	2+G	6-20P or L6-20P	N/A	N/A	N/A	1,300
MD685R	72.00	74.25	3.00	Self-Contained (R290)	Circuit #1	208-240	1	60	24.00	3,863	2+G	6-30P or L6-30P	N/A	N/A	N/A	1,650

*** Does not include electric defrost on freezer models.

Regulatory Approvals:

All Models
 Accordance with AHRI Std 1200
 ETL Listed to UL 471
 ETL Sanitation to NSF/ANSI 7



In Accordance with
AHRI Std 1200

DOE 2017
Energy Efficiency
Compliant

Important Notes:

- Units must be shimmed during installation to ensure the unit is level and plumb.
- Keep unit at least 15' from exterior doors, overhead HVAC vents, or any air curtain disruption.
- Performance issues (product temperatures, water on floor, etc.) caused by adverse conditions are not covered by warranty.

⚠ WARNING: This product can expose you to chemicals, including Urethane (Ethyl Carbamate), which are known to the State of California to cause cancer and birth defects or other reproductive harm. For more information go to www.P65Warnings.ca.gov.