

**Sinks Include Faucet & Drain**



**DI-1-168**  
18 Gauge



**DI-1-208**  
18 Gauge



**DI-1-2012**  
18 Gauge



**DI-1-30**  
20 Gauge

**LARGEST ONE  
COMPARTMENT  
DROP-IN SINK IN  
THE INDUSTRY!**

**Supplied with  
K-53 Faucet**

**DI-1-2812**  
16 Gauge



**FEATURES:**

One piece seamless **Deep Drawn** sink bowl design.

All sink bowls have a large liberal radii with a minimum dimension of 2" and are rectangular in design for increased capacity.

Self-Rim Design. Mounting clips provided fit counters 7/8" to 2" thick. (Quantity supplied varies based on drop in sink ordered).

**DI-1-30 & DI-1-168:** includes 4" O.C. **K-52** faucet.

**DI-1-208 & DI-1-2012:** includes 4" O.C. **K-50** faucet.

**DI-1-2812:** includes 4" O.C. **K-53** faucet.

**CONSTRUCTION:**

Unit fabricated from one sheet of stainless steel.

All bowls are Sound Deadened.

Units feature Advance Tabco's **Smart Finish™**.

**MECHANICAL:**

Faucet supply is 1/2" IPS male thread.

Deck mounted faucet is furnished with aerator.

**Faucet Flow Rate:** 1.0 GPM/3.8 LPM aerator. 60 PSI.

**MATERIAL:**

Type 304 series stainless steel.

Faucets are brass-nickel plated.

Stainless Steel 1-1/2" IPS basket drain.

**Available Faucets & Accessories**

Model #	Qty
Deck Mounted 8" Swing Spout. 4" O.C.	<b>K-50</b>
Deck Mounted Gooseneck. 4" O.C.	<b>K-52</b>
Deck Mounted. 12" Swing Spout. 4" O.C.	<b>K-53</b>
Deck Mounted 8 1/2" Gooseneck. 4" O.C.	<b>K-55</b>
Deck Mounted Swing w/Spray. 8" O.C.*	<b>K-58</b>
Deck Mtd. X.H.D. 3 1/2" Gooseneck. 4" O.C.	<b>K-62</b>
Mounting Clips (Bag of 4).	<b>K-28</b>

\*REQUIRES **K-472** FAUCET HOLE REVISION



**STANDARD MOUNTING CLIPS**

For countertops over 7/8" and up to 2" thick.

Replacement # **K-28** (Per Sink)

**WARNING:** Faucets on this page may expose you to chemicals, including lead, that are known to the State of California to cause cancer or birth defects or other reproductive harm. For more Info., visit [www.p65warnings.ca.gov](http://www.p65warnings.ca.gov).

# DIMENSIONS and SPECIFICATIONS

TOL  $\pm .125"$

ALL DIMENSIONS ARE TYPICAL

## DI-1-208 & DI-1-2012

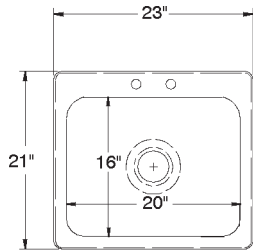

**Cut-Out Size**  
22 1/4" x 20 1/4"  
1 1/4" radius corners

### DI-1-208

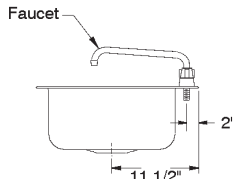
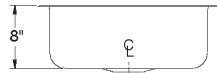

Approx. Wt. 18 lbs.

### DI-1-2012

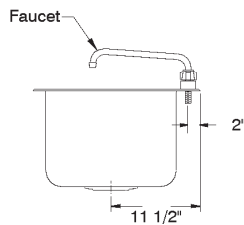
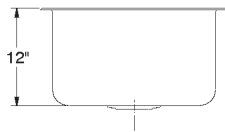

Approx. Wt. 20 lbs.

Supplied with K-50 Faucet

## DI-1-168

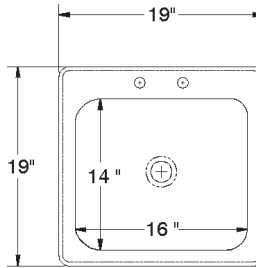

**Cut-out Size**  
18 1/4" x 18 1/4"  
1 1/4" radius corners

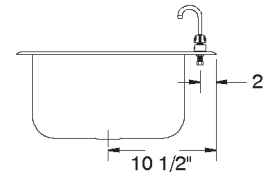
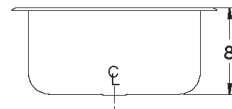

Supplied with K-52 Faucet

Approx. Wt. 15 lbs.

## DI-1-30

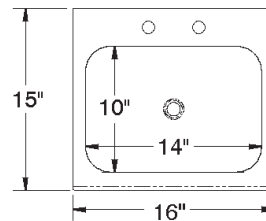

**Cut-Out Size**  
15" x 14 1/4"  
1 1/4" radius corners

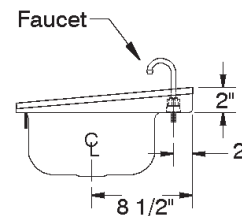
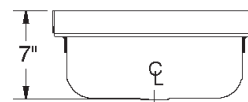

Supplied with K-52 Faucet

Approx. Wt. 11 lbs.

## DI-1-2812

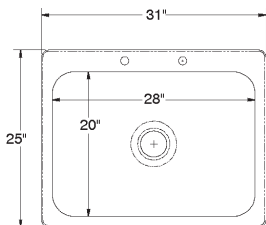

**Cut-out Size**  
30 1/4" x 24 1/4"  
1 1/4" radius corners

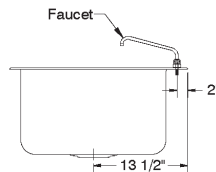
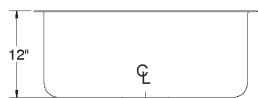

Approx. Wt. 42 lbs.

Supplied with K-53 Faucet

## TYPICAL INSTALLATION

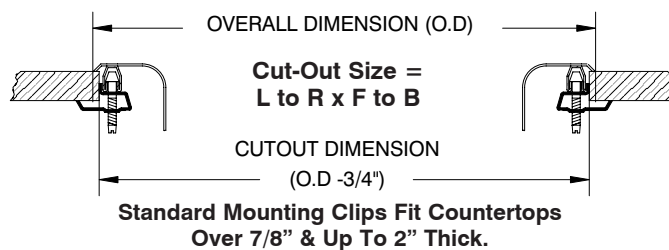

REF-A

325 Wireless Boulevard, Hauppauge, NY 11788

ADVANCE TABCO is constantly engaged in a program of improving our products. Therefore, we reserve the right to change specifications without prior notice.

© ADVANCE TABCO, AUGUST 2025