

Specification/Datasheet

Kit with rollers for Combi-Duo type 6-half size, 10-half size



Article number

60.31.622

Description

Mobile kit with rollers for a low set-up of an iCombi Pro

Intended use

This product is intended exclusively for professional use, such as in restaurant kitchens or catering operations for schools, hospitals, or delis. Any other use runs counter to its intended purpose, and could be dangerous. RATIONAL AG assumes no liability for consequences of improper use.

Features

- 4 rollers for the mobile installation of a Combi-Duo
- The height of each roller can be infinitely leveled
- Enables adjustment by up to 3/4 in (20 mm) to compensate for height differences for floor installation

Technical specifications

Max. fixed power:	1,320 lb (.600 kg)
-------------------	--------------------

Dimensions and weights

Width (W):	34 3/4 in (883 mm)
Height (H):	3 3/8 in (85 mm)
Depth (D):	30 3/8 in (773 mm)
Weight:	21.4 lb (9.7 kg)

Material

Stainless steel (CNS 1.4301/AISI 304)

Specification/Datasheet

Kit with rollers for Combi-Duo type 6-half size, 10-half size

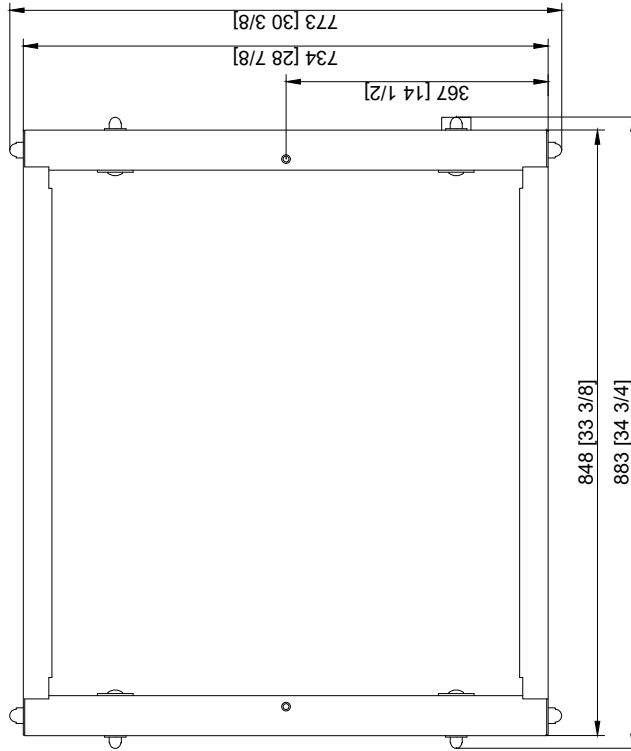
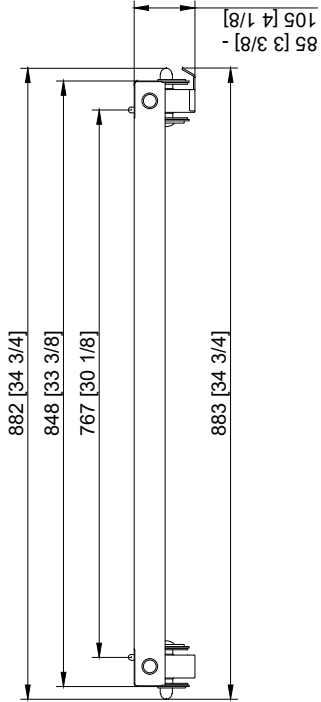
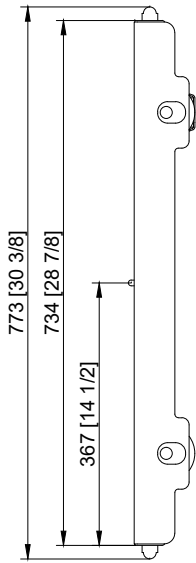

Information/Formation/Information		Anschlussjahr/Connection diagram/Plan de connexion	
Zzeichnungsausschnitt unterliegt nicht dem Verwendungsrecht und automatisch update! La mise à jour n'est pas assurée sur les plans papier		60.3x.622 Kit for mobile Combi-Duo (Combi 6-11 and 10-11 (60mm - 100mm - casters) (master view)	
©RATIONAL AG 2022		RATIONAL AG 2022	
Revision/Revision/Revisión		Abmessungen/Dimensions/Dimensions	
Index	Datum/Date/Date	Name/Name/Nom	Nr./No. Beschreibung/Description/Description
1			1
2			2
3			3
4			4