

# SYLVANIA LEDVANCE

## Vapor Tight Connector Installation



An official product licensee  
of trademark SYLVANIA  
in general lighting in the  
USA and Canada.

SYLVANIA.COM



Required Materials:

(2) SYLVANIA LEDVANCE Vapor Tight

(1) Vapor Tight Connector (74920)



# SYLVANIA LEDVANCE

## Vapor Tight Connector Installation

1. Remove 2<sup>nd</sup> knockout from luminaire 1 (be sure when assembling that knockout from luminaire 2 is facing toward luminaire 1)
2. Unscrew the ends of the connector. (Do not remove the rubber gaskets from either side of the connector)

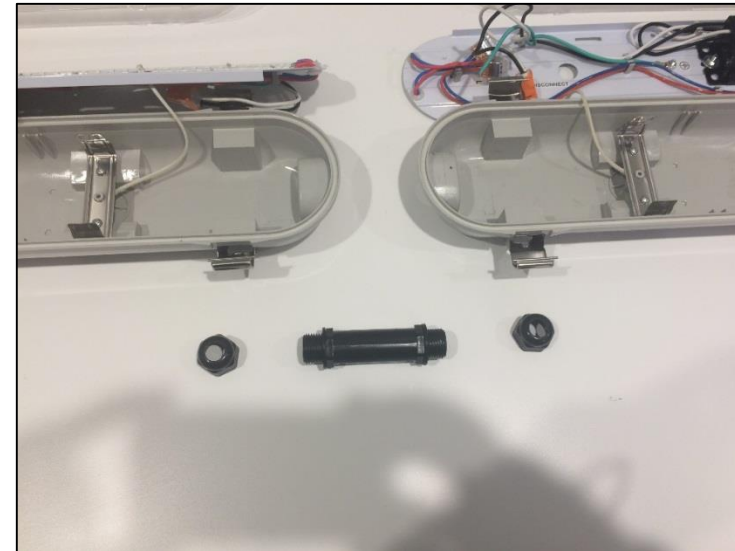
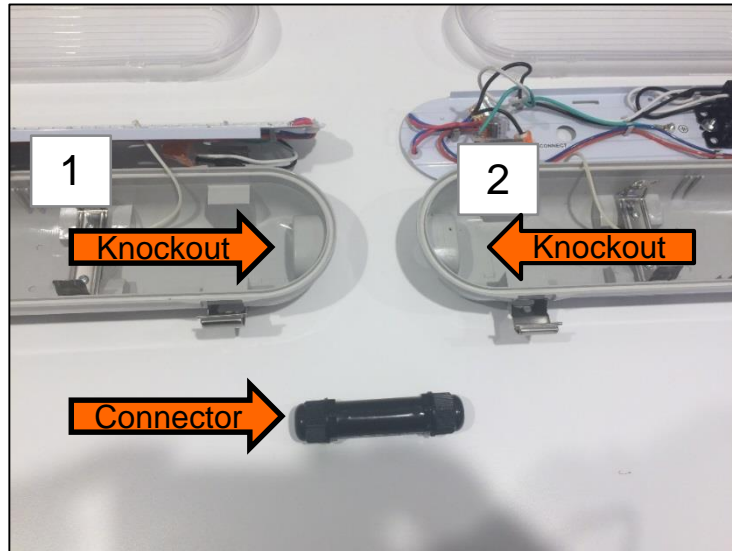

# SYLVANIA LEDVANCE

## Vapor Tight Connector Installation

3. Insert the connector into the removed knockout of vapor tight 1
4. Screw head back onto connector, tightening as much as possible

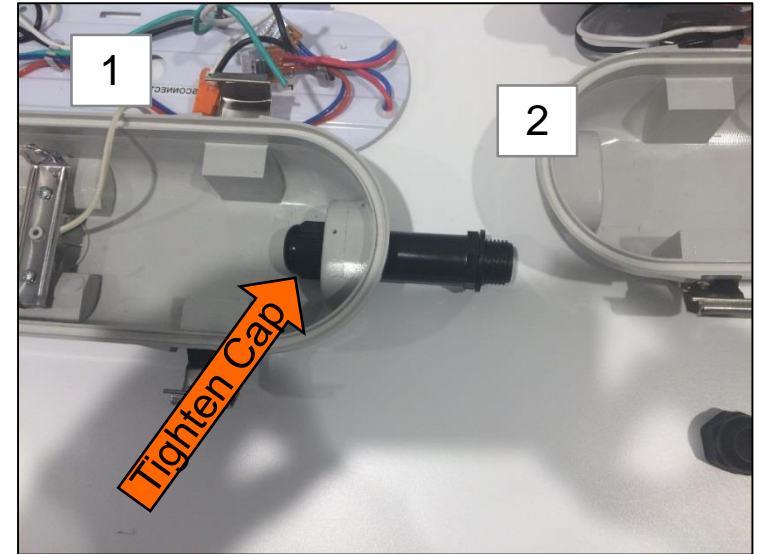
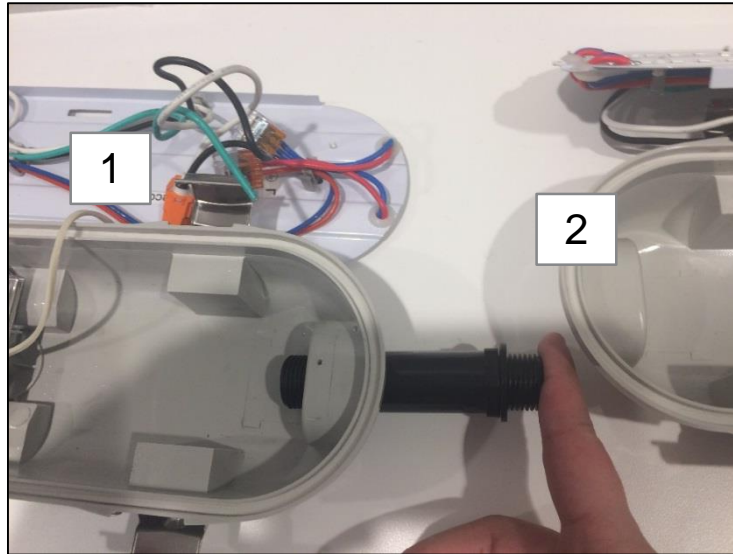
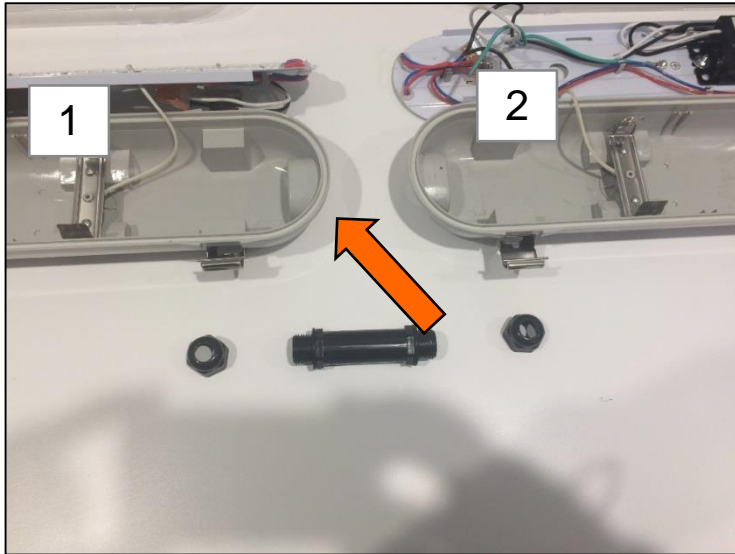

# SYLVANIA LEDVANCE

## Vapor Tight Connector Installation

5. Insert connector into knockout from vapor tight 2
6. Screw head back onto connector, tightening as much as possible

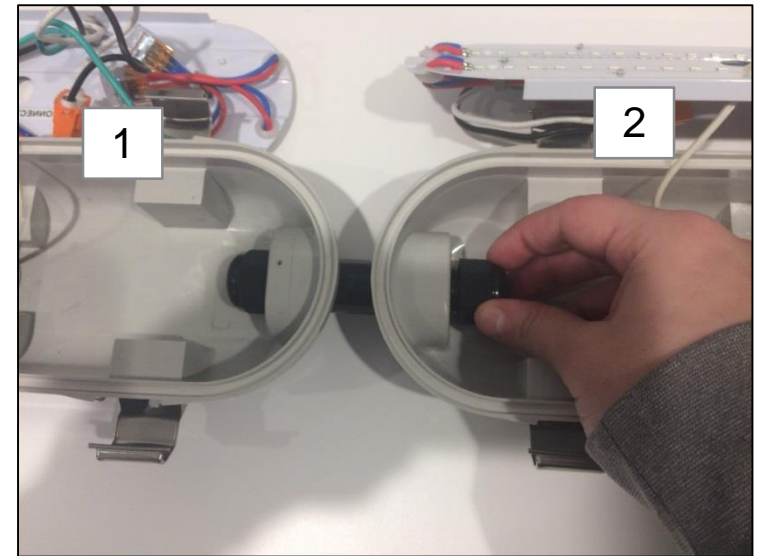
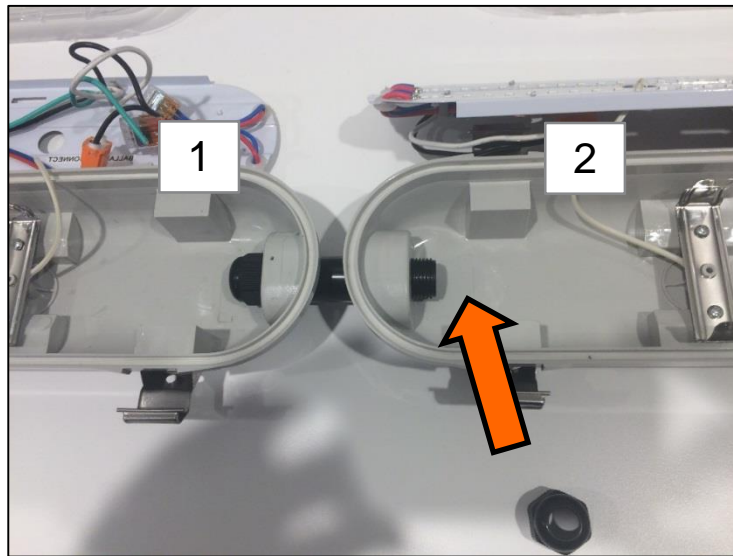
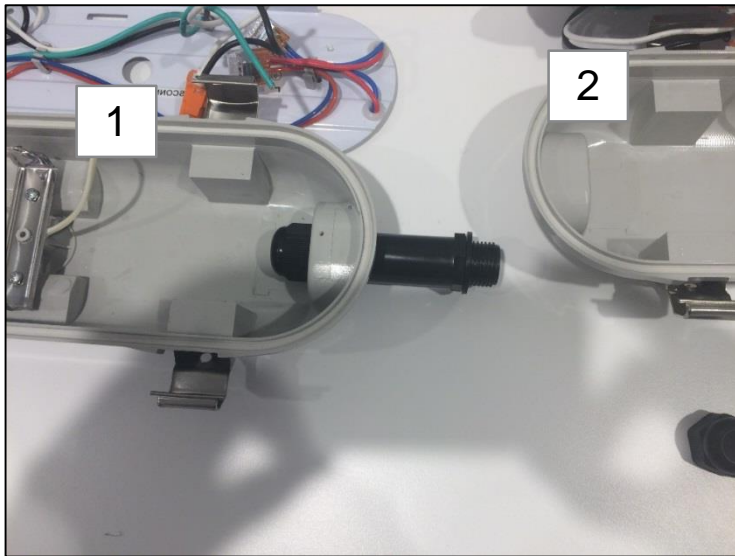

# SYLVANIA LEDVANCE

## Vapor Tight Connector Installation – Wiring the Fixtures

7. Bring incoming power through 1<sup>st</sup> knockout of vapor tight 1
8. Remove existing orange wire connector from vapor tight 1
9. Connect 2<sup>nd</sup> set of wires to orange wire connectors in vapor tight 2
10. Run 2<sup>nd</sup> set of wires from vapor tight 2 orange connector back through vapor tight connector to vapor tight 1
11. Using a wire nut (or other connector) connect vapor tight 1, vapor tight 2, and incoming power (black to black, white to white)

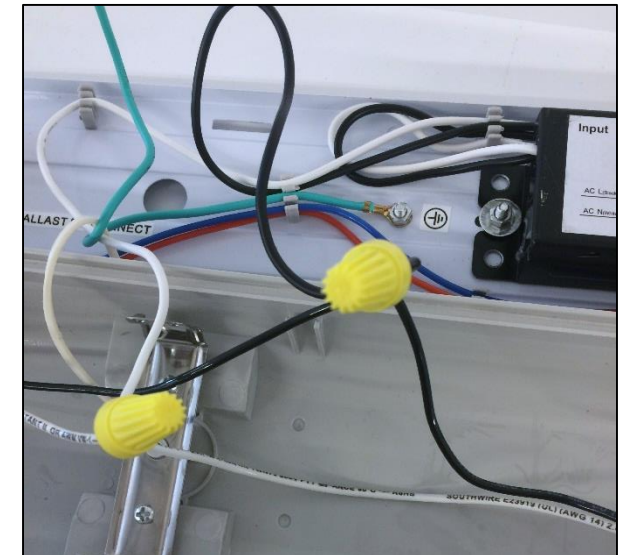
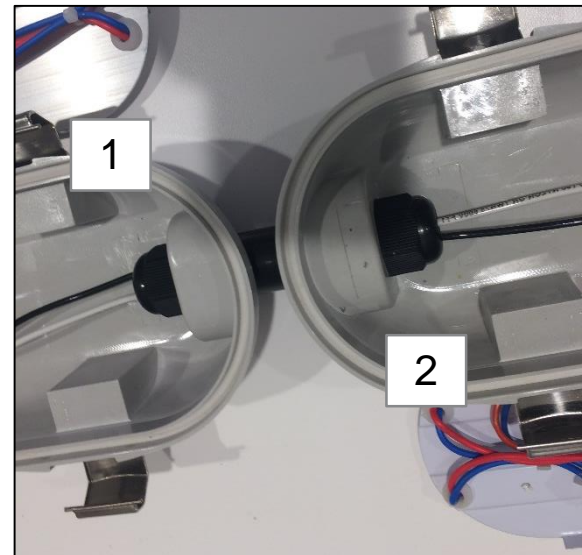
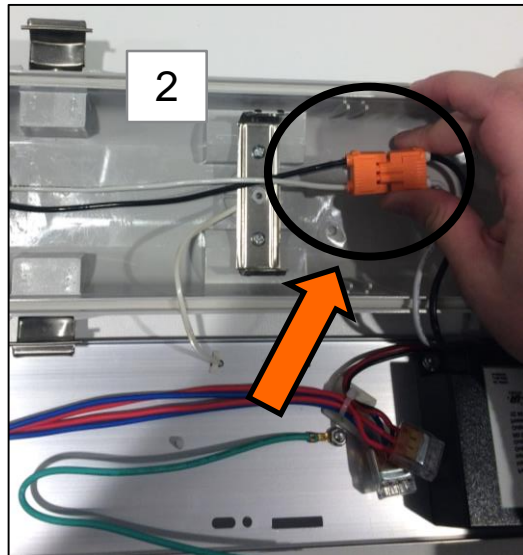
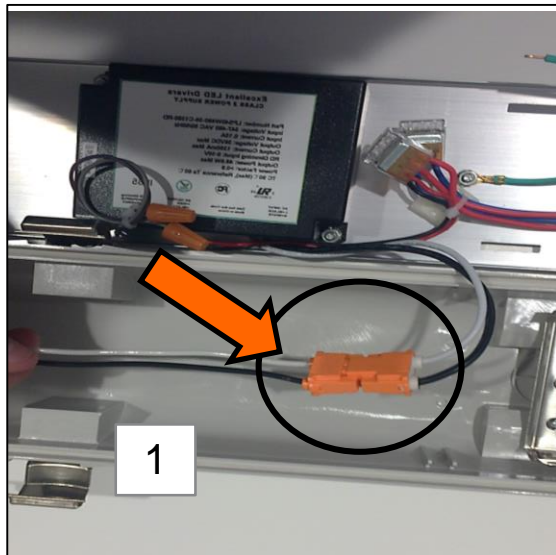

# SYLVANIA LEDVANCE

## Vapor Tight Connector Installation – Mounting the Fixture

---

- 12a. If **surface mounting**: put all included brackets on back and install as normal
- 12b. If **chain mounting**: install v-hooks and chains onto both luminaires and hang as normal
- 12c. If **pendant mounting**: install a minimum of 3 pendants (1 at junction of 2 vapor tights)