

M-8921

4

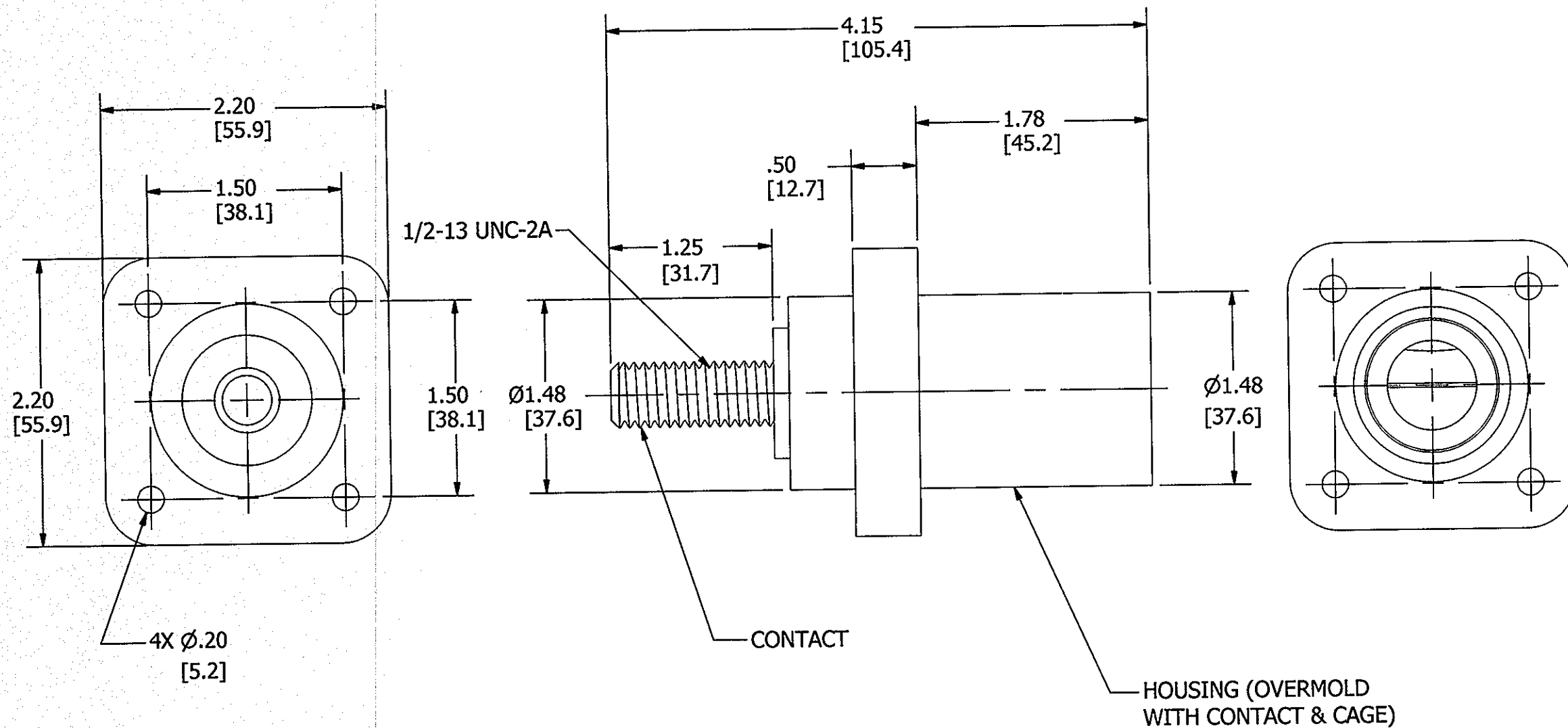

NOTES:

1. DIMENSIONS ARE IN INCHES  $\pm .02$   
[mm]  $\pm .5$
2. RATING : 600VAC/250VDC 400 AMP.
3. UL/c-UL ENCLOSURE TYPES 3R, 4X, 12,  
SEE INSTRUCTION SHEET.

CODE 74545

HUBBELL CAT. NO.	COLOR
HBLMRSBK	BLACK
HBLMRSW	WHITE
HBLMRSGN	GREEN
HBLMRSR	RED
HBLMRSDL	BLUE
HBLMRSDO	ORANGE
HBLMRSDN	BROWN
HBLMRSDY	YELLOW

LIST OF PARTS

DESCRIPTION	MATERIAL	FINISH
HOUSING	TPE	SEE TABLE
CONTACT	BRASS	
CAGE	NYLON	BLACK

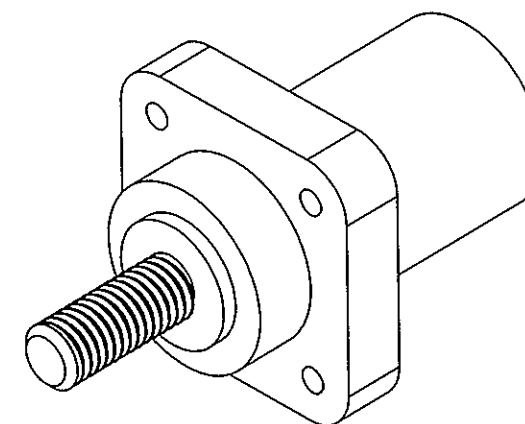

CATALOG NO. HBLMRSBK  
(NOT SHOWN TO SCALE)

4	REDRAWN WITH EMBEDDED CAD MODEL WITH NO CHANGES TO PART GEOMETRY. PER DCN 21895 SPN	DJP <i>DJP</i>	2/5/16
REV	DESCRIPTION	APP	DATE

THE DESIGN AND DIMENSIONS OF THE  
PRODUCT SHOWN ON THIS DRAWING ARE  
SUBJECT TO CHANGE WITHOUT NOTICE

TITLE  
SINGLE POLE MALE RECEPTACLE  
W/STUD

TOLERANCES UNLESS OTHERWISE SPECIFIED		WIRING DEVICE-KELLEMS HUBBELL INCORPORATED SHELTON, CT	
.XX = $\pm .01$	DR. BY MJM	APP. BY TWB	
.XXX = $\pm .005$	TR. BY	SCALE 1:1	
ANGLES = $\pm 2^\circ$	CHK. BY TWB	DATE 6/11/03	

DIMENSION SHEET FOR CAT. NO.  
SEE TABLE

REPAIRABLE ☐ NON-REPAIRABLE ☐

B

M-8921

4