



HW1991ISR-3

HW19

MOBILE HANDHELD SCANNERS

SICK
Sensor Intelligence.



Ordering information

Type	Part no.
HW1991ISR-3	2123086

Other models and accessories → www.sick.com/HW19



Detailed technical data

Features

Task	Identifying - 1D code Identifying - 2D code
Version	Standard Range
Application	Industrial application
Scanner design	Wireless variant
Sensor resolution	1,280 px x 800 px
Light source	LED, Visible, Red, 625 nm
Alignment aid	Laser, Red, 655 nm
Reading distance	0 mm ... 837 mm
Code resolution	≥ 0.076 mm ¹⁾ ≥ 0.152 mm ²⁾

¹⁾ Valid for Code 39.

²⁾ Valid for Data Matrix code.

Mechanics/electronics

Supply voltage	4 V DC ... 5.5 V DC
Current consumption	Charging (5 V DC): 1 A Standby: 120 mA
Housing	Plastic (UL 94 V-0)
Housing color	Orange, gray
Enclosure rating	IP65 IP67
Weight	405 g, incl. rechargeable battery
Dimensions (L x W x H)	100 mm x 76 mm x 192 mm

Performance

Readable code structures	1D codes, 2D codes, Stacked, Digimarc®
Bar code types	Code 39, Code 39 Trioptic, Code 32, Code 93, Code 11, Codabar, Code 128, GS1-128 / EAN 128, UPC / EAN / JAN (with addition), MSI/Plessey, UK/Plessey, IATA, Interleaved 2 of 5, Stan-

	Standard and Industrial 2 of 5, Matrix 2 of 5, Telepen, GS1 DataBar, Australian Post, China Post, German Post, US Planet, US Postnet, British Post, Intelligent Mail, Japan Post, Korean Post, Dutch KIX Post
2D code types	Data Matrix, QR code, MicroQR-Code, Aztec, MaxiCode, Digimarc, DOT Code, CodaBlock A/F, GS1, Chinese Sensible Code, OCR symbologies
Stacked code types	PDF417, MicroPDF417, Code 49, Code 16K, Composite, Codablock F
Code alignment	Omni-directional
Horizontal motion tolerance	Typ. 450 cm/s
Battery power	Up to 50,000 scans when fully charged, 14 h continuous operation at 1 scan/s
Code buffer	5,000 Codes (EAN, for scanning in batch mode)

Interfaces

Ethernet	✓
Type of fieldbus integration	Optional, over external connection module CDF600-2
Remark	TCP/IP
USB	✓
Function	Keyboard wedge, COM-Port emulation
PS/2	✓
Function	Keyboard wedge
Serial	✓, RS-232 TTL
Remark	Optionally possible via cable
PROFIBUS DP	✓
Type of fieldbus integration	Optional over external fieldbus module CDF600-2
Function	PROFINET Single Port, PROFINET Dual Port
PROFINET	✓
Type of fieldbus integration	Optional over external fieldbus module CDF600-2
Bluetooth	✓
Remark	Bluetooth™ V2.1 EDR, 2.4 ... 2.4835 GHz
Function	Wireless operating range up to 100 m (free view), batch function for expansion of the wireless radius, up to seven scanners communicate with one base station
EtherCAT	✓
Type of fieldbus integration	Optional over external fieldbus module CDF600
Optical indicators	3 LEDs (good read, charge of battery, radio connection status)
Acoustic indicators	Beeper, can be switched off
Vibration	Yes
Configuration software	EZConfig Tool (≥ V.4.5.35)

Ambient data

Shock resistance	50 drop samples at -30 °C ... +50 °C from 2 m height on concrete 20 drop samples at 25 °C, 55% rel. air humidity onto concrete from a height of 2.4 m Onto concrete from a height of 3 m
Ambient operating temperature	-20 °C ... +50 °C
Storage temperature	-40 °C ... +70 °C
Permissible relative humidity	95 %, Non-condensing
Ambient light immunity	100,000 lx
Bar code print contrast (PCS)	≥ 20 %

General notes

Items supplied	The rechargeable battery is included with delivery
Note	A base station, power supply unit, and connecting cable may be required for operation.

Classifications

ECLASS 5.0	27280101
ECLASS 5.1.4	27280101
ECLASS 6.0	27280101
ECLASS 6.2	27280101
ECLASS 7.0	27280101
ECLASS 8.0	27280101
ECLASS 8.1	27280101
ECLASS 9.0	27280101
ECLASS 10.0	27280101
ECLASS 11.0	27280101
ECLASS 12.0	27280101
ETIM 5.0	EC002550
ETIM 6.0	EC002550
ETIM 7.0	EC002550
ETIM 8.0	EC002550
UNSPSC 16.0901	43211701

Connection diagram

PROFINET IO/RT

PROFINET IO/RT

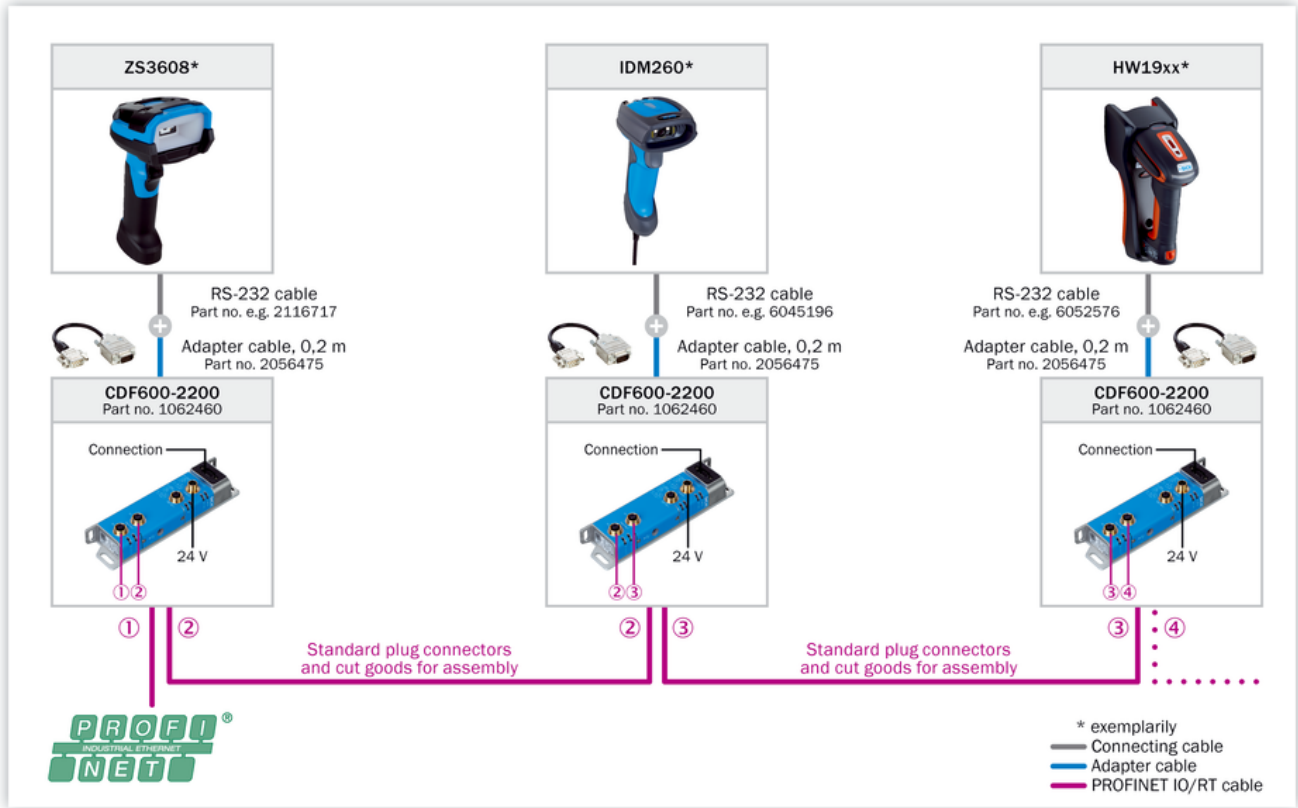

PROFIBUS DP

PROFIBUS DP

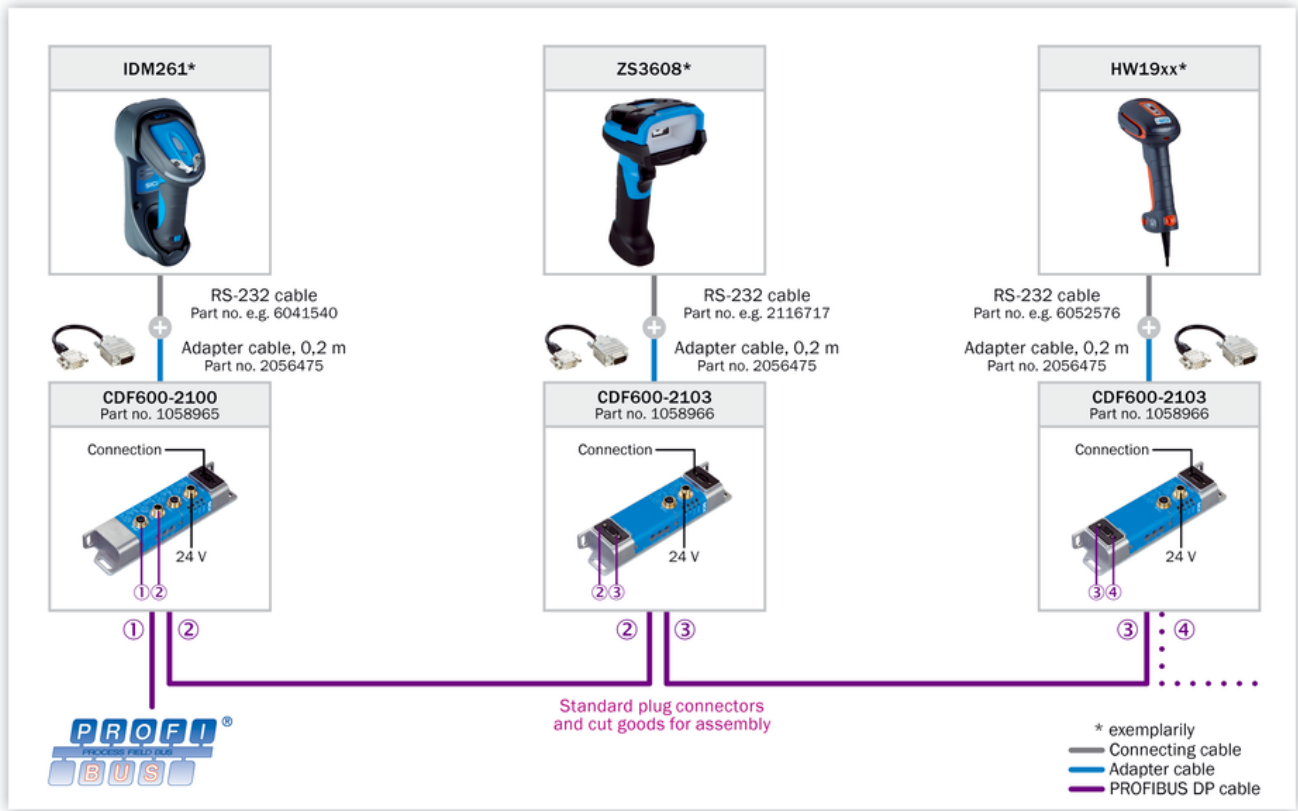

EtherCAT®

EtherCAT®

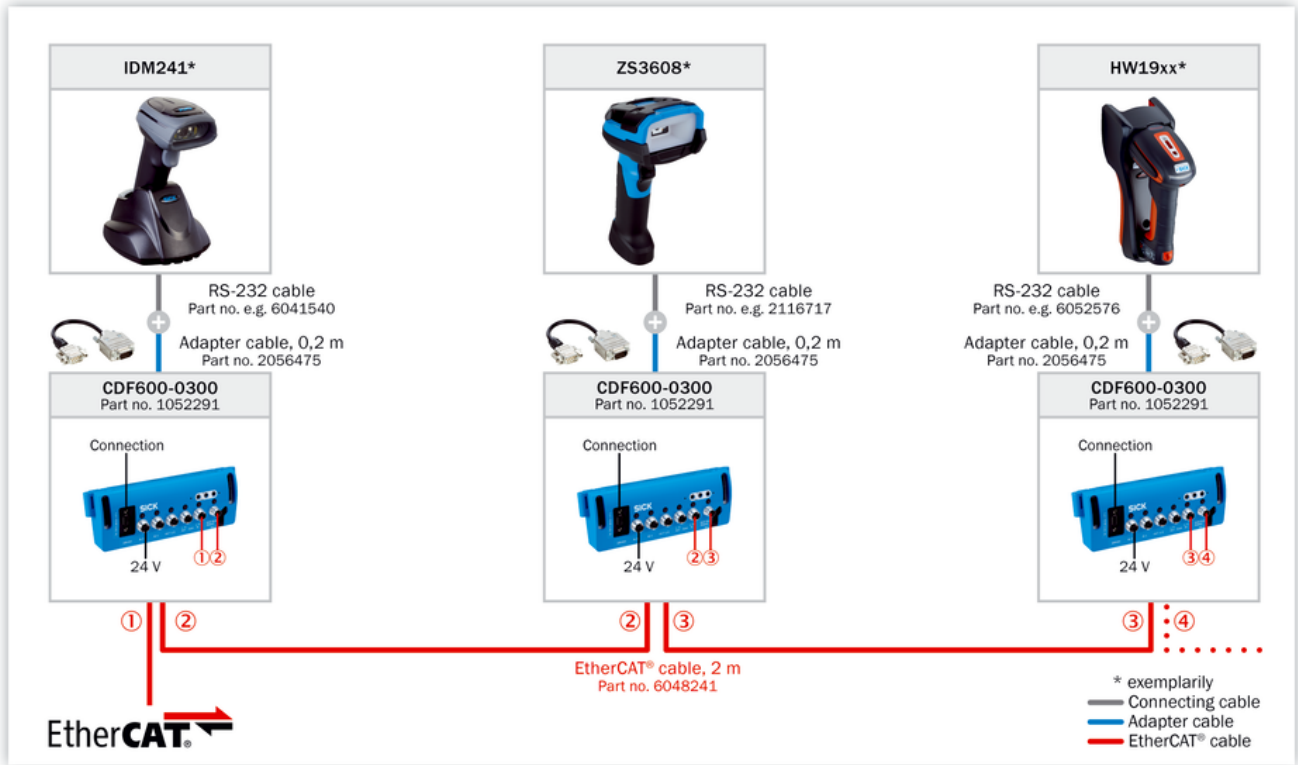

AUX looping

Looping-in via AUX

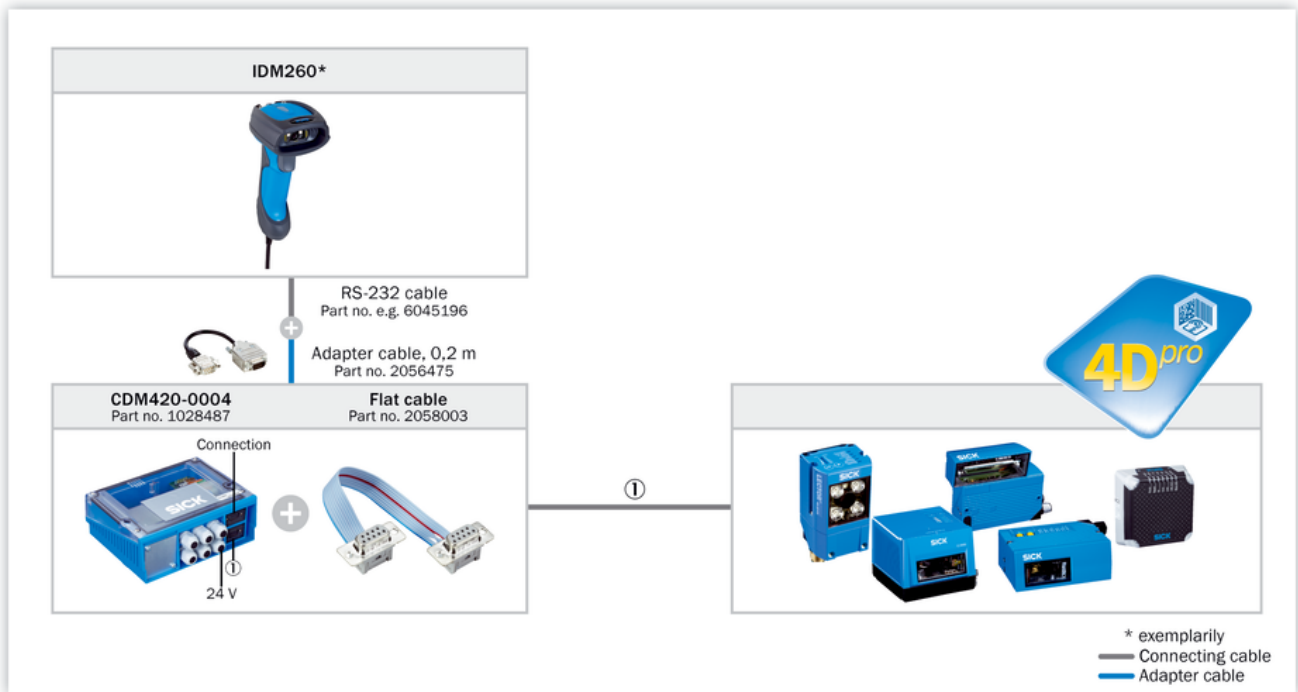

Selection Guide



*) For EtherNet/IP third party gateway is required from e.g. Control or HMS (requires local sourcing).

HW199x

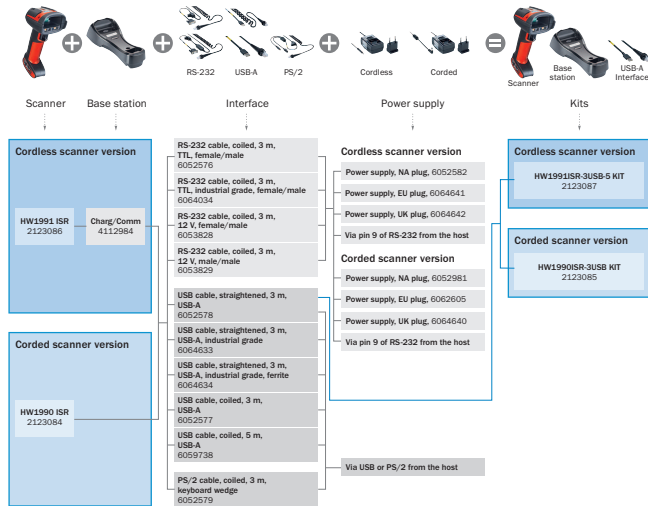

Optional accessories for all scanner versions¹⁾



¹⁾ Extract from product portfolio. Other variants are available.





Optional accessories only for cordless scanner versions



Recommended accessories

Other models and accessories → www.sick.com/HW19

	Brief description	Type	Part no.
Fieldbus modules			
	Connection kit for connecting a hand-held scanner to a PROFINET (Siemens) interface	Hand-held scanner PROFINET kit	1101488
	Adapter for connecting a handheld scanner to CDB620 / CDM420 / CDF600 / CD-F600-2, D-Sub 9-pin male connector, D-Sub 15-pin male connector, including 24V / 5V DC converter, AUX port adapter, for handheld scanners to CDB620/CDM420/ CDF600/CD-F600-2, adapter AUX port	YMHDAC-C30XXXMSA9	2056475
Rechargeable batteries and battery chargers			
	Charging/Communication station for HW1911 / HW1991, Bluetooth class 1, 100 m, host interfaces: RS-232 / USB / KBW (Honeywell CCB22-100BT-03N)	Base station	4112984
	<ul style="list-style-type: none"> Connection type head A: Male connector, USB-A Connection type head B: Male connector, RJ45 Signal type: USB Cable: 3 m, straightened cable Description: USB, Keyboard connector or USB Com Port Emulation, 5 V host power (Honeywell CBL-500-300-S00) 	USB cable	6052578

	Brief description	Type	Part no.
	<ul style="list-style-type: none"> • Connection type head A: Female connector, D-Sub, 9-pin, straight • Connection type head B: Male connector, RJ45 • Signal type: RS-232 TTL • Cable: 3 m, coiled cable • Description: RS-232 TTL, 5 V external voltage supply with option for host voltage supply on pin 9 (Honeywell CBL-020-300-C00) 	Connection cable (male connector-female connector)	6052576
	Power supply unit with UK male connector for charging station, 1 A, 5.2 V DC, 90 V AC ... 255 V AC at 50 Hz ... 60 Hz (Honeywell PS-05-1000W-G)	Power supply unit	6064642
	Power supply unit with EU male connector for charging station, 1 A, 5.2 V DC, 90 V AC ... 255 V AC at 50 Hz ... 60 Hz (Honeywell PS-05-1000W-C)	Power supply unit	6064641
	Power supply unit with NA male connector for charging station, 1 A, 5.2 V DC, 90 V AC ... 255 V AC at 50 Hz ... 60 Hz (Honeywell PS-05-1000W-A)	Power supply unit	6052582

SICK AT A GLANCE

SICK is one of the leading manufacturers of intelligent sensors and sensor solutions for industrial applications. A unique range of products and services creates the perfect basis for controlling processes securely and efficiently, protecting individuals from accidents and preventing damage to the environment.

We have extensive experience in a wide range of industries and understand their processes and requirements. With intelligent sensors, we can deliver exactly what our customers need. In application centers in Europe, Asia and North America, system solutions are tested and optimized in accordance with customer specifications. All this makes us a reliable supplier and development partner.

Comprehensive services complete our offering: SICK LifeTime Services provide support throughout the machine life cycle and ensure safety and productivity.

For us, that is “Sensor Intelligence.”

WORLDWIDE PRESENCE:

Contacts and other locations –www.sick.com